

CLEATED PLASTIC BELT CONVEYOR



Titan offers a variety of belt widths from 4" to 60" wide in a variety of belt types with cleat height ranging from 1" to 3" depending on your needs. Most of Titan's complete line of conveyors can be adapted to plastic belts depending on your needs.

Cleated plastic belts are ideal for:

- small parts
- delicate materials
- automotive parts
- scrap handling and recycling

CLEATED PLASTIC BELT CONVEYOR	
STANDARD	
Belt Widths	3 1/4" to 6'
Belt Type	Polypropylene, Acetal
Lengths	Per application
Curves	15°, 30°, 45°, 60°
Drive	1/2 H.P. 230/460/3/60
Frame	Formed 12 ga.
OPTIONS	
Stainless construction, Interlox belt, customized siderails, Top, Bottom or side mount drive, Fixed speeds - specify speed required, variable speed with DC motor and SCR controller or AC inverter, Paint choice	

NOTE: Specifications subject to change without notice

CLEATED PLASTIC BELT CONVEYOR

Many Belt Types Available - Contact Factory

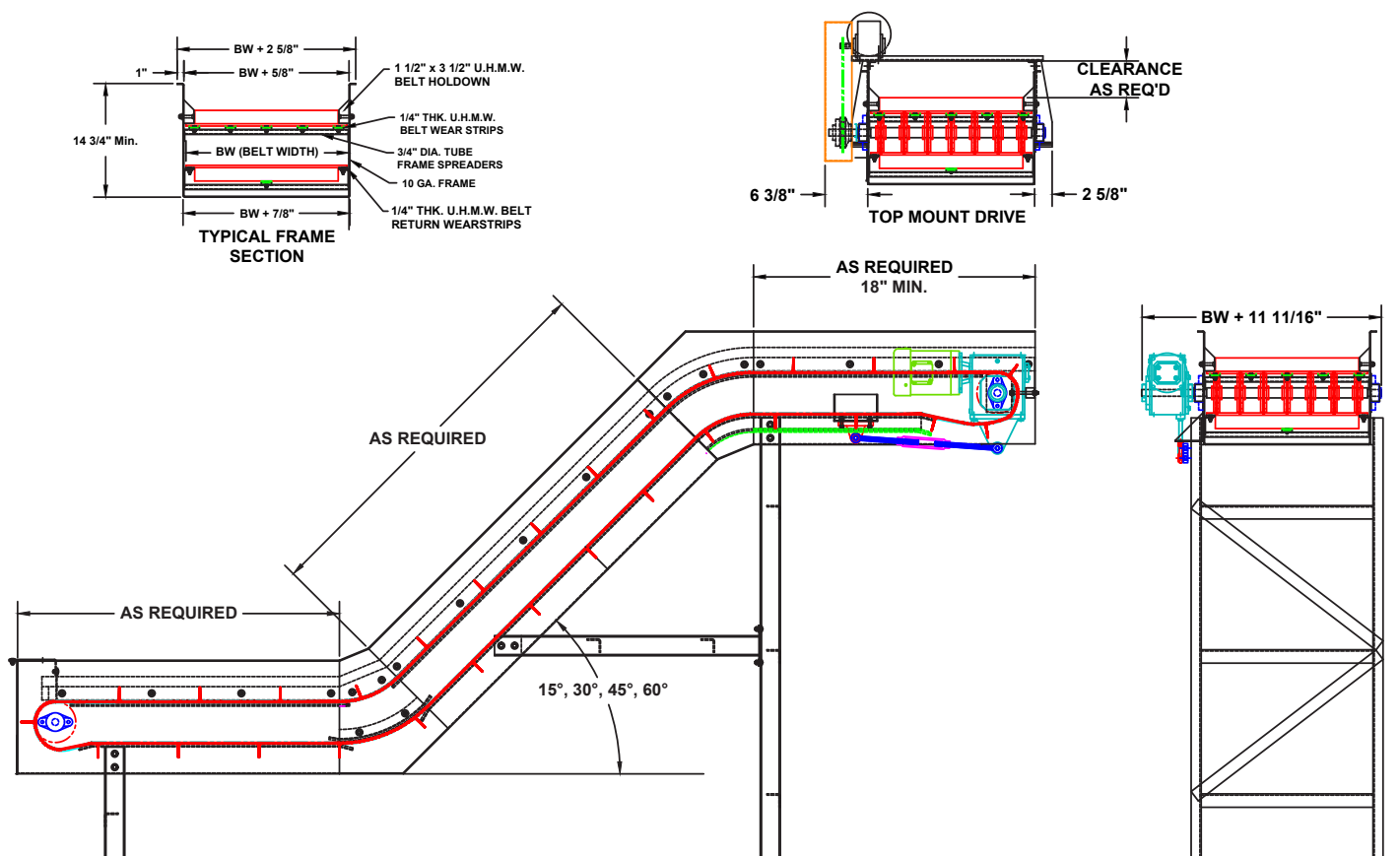
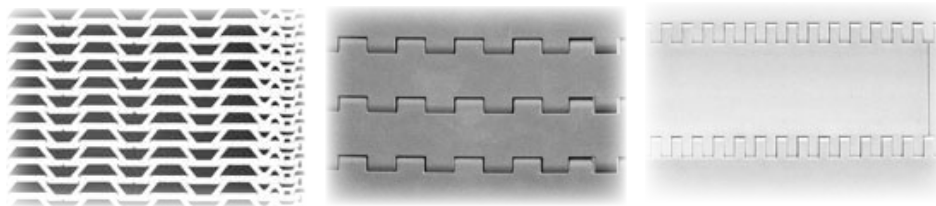

Profiles Available

TYPE 1



TYPE 2

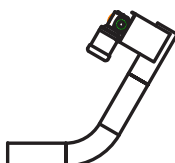

TYPE 3

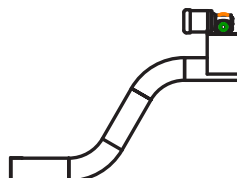

TYPE 4

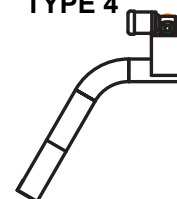

TITAN
CONVEYORS

735 Industrial Loop Road • New London, WI 54961-9612
920-982-6600 • Fax 920-982-7750 • Toll Free 800-558-3616
Website: www.titanconveyors.com • Email: sales@titanconveyors.com